

# CORD-END SLEEVE



DIN 46228/4 END SLEEVES WITH INSULATION POLYAMID 66

Temperature range: -40°C up to + 105 °C

Material: copper Tube with Tin plated.

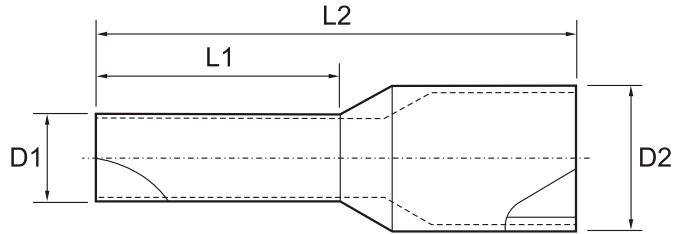

Unit:mm

ITEM NO.	WIRE RANGE (mm <sup>2</sup> )	D1	D2	L1	L2	COLOR SYSTEM			PACKING
						T(FRENCH)	W(GERMAN)	D(DIN)	
CE001406	0.14	0.70	1.60	6	10		GRAY		1000 PCS
CE001408				8	12				
CE002506	0.25	0.75	1.90	6	10	VIOLET	LIGHTBLUE		
CE002508				8	12	TURQUOISE			
CE003406	0.34	0.80	1.90	6	10	PINK	TURQUOISE		
CE003408				8	12				
CE005006	0.50	1.00	2.60	6	12	WHITE	ORANGE	WHITE	500PCS
CE005008				8	14				
CE005010				10	16				
CE007506	0.75	1.20	2.80	6	12				
CE007508				8	14				
CE007510				10	16	BLUE	WHITE	GRAY	
CE007512				12	18				
CE010006	1.00	1.40	3.00	6	12				
CE010008				8	14				
CE010010				10	16	RED	YELLOW	RED	
CE010012				12	18				
CE015008	1.50	1.70	3.50	8	14				
CE015010				10	16				
CE015012				12	18	BLACK	RED	BLACK	
CE015018				18	20				
CE025008	2.50	2.20	4.20	8	14				
CE025010				10	16	GRAY	BLUE	BLUE	
CE025012				12	18				
CE025018				18	24				
CE040010	4.00	2.80	4.80	10	17				
CE040012				12	20	ORANGE	GRAY	GRAY	
CE040018				18	26				
CE060012	6.00	3.50	6.30	12	20				
CE060018				18	26	GREEN	BLACK	YELLOW	
CE100012	10.00	4.50	7.60	12	22				
CE100018				18	28	BROWN	IVORY	RED	
CE160012	16.00	5.80	8.80	12	24				
CE160018				18	28	IVORY	GREEN	BLUE	
CE250016	25.00	7.30	11.20	16	30				
CE250018				18	30	BLACK	BROWN	YELLOW	
CE250022				22	36				
CE350016	35.00	8.30	12.70	16	30				
CE350018				18	32	RED	BEIGE	RED	
CE350025				25	39				
CE500020	50.00	10.30	15.00	20	36				
CE500025				25	40	BLUE	OLIVE	BLUE	
CE700021	70.00	13.50	16.00	21	37	YELLOW	YELLOW	YELLOW	100PCS
CE950025	95.00	14.70	18.00	25	44	RED	RED	RED	
CE120027	120.00	16.70	20.00	27	48	BLUE	BLUE	BLUE	
CE150032	150.00	19.50	23.00	32	58	YELLOW	YELLOW	YELLOW	

# CORD-END TWIN SLEEVE

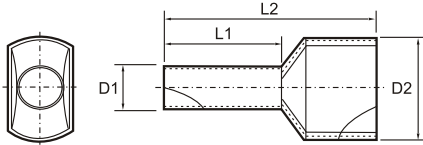

ITEM NO.	WIRE RANGE (mm <sup>2</sup> )	D1	D2	L1	L2	COLOR SYSTEM			PACK-ING
						T(FRENCH)	W(GERMAN)	D(DIN)	
CT205008	2x0.50	1.5	2.5/4.7	8.0	15.0	WHITE	ORANGE	WHITE	500 pcs
CT207508	2x0.75	1.8	2.8/5.0	8.0	15.0	BLUE	WHITE	GRAY	
CT207510				10.0	17.0				
CT210008	2x1.00	2.05	3.4/5.4	8.0	15.0	RED	YELLOW	RED	
CT210010				10.0	17.0				
CT215008	2x1.50	2.3	3.6/6.6	8.0	16.0	BLACK	RED	BLACK	
CT215012				12.0	20.0				
CT225010	2x2.50	2.8	4.2/7.8	10.0	18.5	GRAY	BLUE	BLUE	
CT225013				13.0	21.5				
CT240012	2x4.00	3.7	4.9/8.8	12.0	23.0	ORANGE	GRAY	GRAY	
CT260014	2x6.00	4.8	6.9/10.0	14.0	26.0	GREEN	BLACK	YELLOW	
CT2100014	2x10.00	6.4	7.6/12.8	14.0	26.5	BROWN	IVORY	RED	
CT2160014	2x16.00	8.3	9.6/18.6	14.0	31.5	IVORY	GREEN	BLUE	

DIN 46228/4 END SLEEVES WITH INSULATION POLYAMID 66  
 Temperature range: -40°C up to + 105 °C  
 Material: copper Tube with Tin plated.

# NON-INSULATED CORD-END SLEEVE

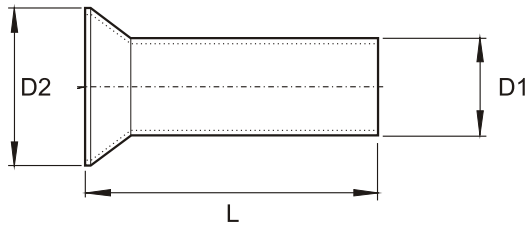

- Material: copper Tube with Tin plated.
- DIN 46228/1

ITEM NO.	WIRE RANGE (mm <sup>2</sup> )	D1	D2	L	PACKING
CN005006	0.50	1.0	2.1	6.0	1000pcs
CN005008				8.0	
CN005010				10.0	
CN007506	0.75	1.2	2.3	6.0	
CN007508				8.0	
CN007510				10.0	
CN010006	1.00	1.4	2.5	6.0	
CN010008				8.0	
CN010010				10.0	
CN010012				12.0	
CN015007	1.50	1.7	2.8	7.0	
CN015008				8.0	
CN015010				10.0	
CN015012				12.0	
CN025007	2.50	2.2	3.4	7.0	
CN025008				8.0	
CN025010				10.0	
CN025012				12.0	
CN025018				18.0	
CN040008	4.00	2.8	4.0	8.0	
CN040009				9.0	
CN040010				10.0	
CN040012				12.0	
CN040015				15.0	
CN040018				18.0	
CN060010	6.00	3.5	4.7	10.0	
CN060012				12.0	
CN060015				15.0	
CN060018				18.0	
CN100012	10.00	4.5	5.8	12.0	
CN100015				15.0	
CN100018				18.0	
CN160012	16.00	5.8	7.5	12.0	
CN160015				15.0	
CN160018				18.0	
CN250015	25.00	7.3	9.5	15.0	
CN250016				16.0	
CN250018				18.0	
CN250020				20.0	
CN250022				22.0	
CN350016	35.00	8.3	11.0	16.0	
CN350018				18.0	
CN350020				20.0	
CN350025				25.0	

CN500018	50.00	10.3	13.0	18.0	1000pcs				
CN500020				20.0					
CN500022				22.0					
CN500025				25.0					
CN700022	70.00	13.5	15.3	22.0		500			
CN700025				25.0					
CN700032				32.0					
CN950025	95.00	14.7	16.6	25.0			500		
CN950032				32.0					
CN120030				30.0					
CN120032	120.00	16.7	18.6	32.0				500	
CN120034				34.0					
CN150032	150.00	19.5	21.5	32.0					500
CN150038				38.0					

## INSULATED SPADE TERMINAL

Unit:mm

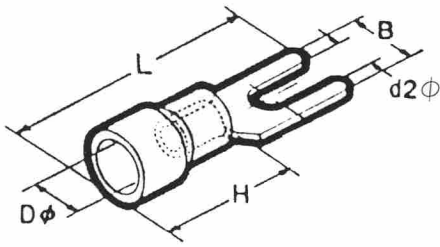

ITEM NO.	DIMENSIONS					WIRE RANGE		COLOR
	d2φ	B	L	H	Dφ	mm <sup>2</sup>	AWG	
VF1.25-3YSA	3.2	5.7	21.0	11.0	4.0	0.5~1.5	22~16	RED
VF1.25-3YS	3.7	5.7	21.0	11.0	4.0			
VF1.25-3YW	3.7	6.2	21.0	11.0	4.0			
VF1.25-4YS	4.3	6.4	21.0	11.0	4.0			
VF1.25-4YW	4.3	7.2	21.0	11.0	4.0			
VF1.25-5Y	5.3	8.0	21.0	11.0	4.0			
VF1.25-6Y	6.4	10.7	22.5	11.0	4.0			
VF2-3YSA	3.2	5.7	21.0	11.0	4.5	1.5~2.5	16~14	BLUE
VF2-3YS	3.7	5.7	21.0	11.0	4.5			
VF2-3YW	3.7	6.2	21.0	11.0	4.5			
VF2-4YS	4.3	6.4	21.0	11.0	4.5			
VF2-4YW	4.3	7.2	21.0	11.0	4.5			
VF2-5Y	5.3	8.0	21.0	11.0	4.5			
VF2-6Y	6.4	10.7	21.0	11.0	4.5			
VF5.5-3Y	3.7	8.2	24.7	13.7	6.3	4.0~6.0	12~10	YELLOW
VF5.5-4Y	4.3	8.2	24.7	13.7	6.3			
VF5.5-5Y	5.3	9.0	24.7	13.7	6.3			
VF5.5-6Y	6.4	12.0	24.7	13.7	6.3			
VF8-6Y	6.4	12.0	32.0	13.7	6.3	8	8	RED

## INSULATED RING TERMINAL

Unit:mm

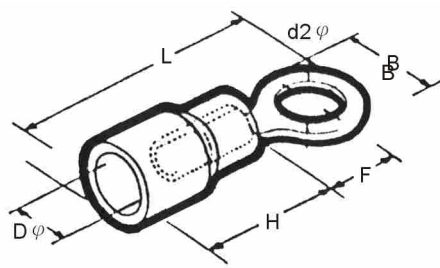

ITEM NO.	DIMENSIONS					WIRE RANGE		COLOR
	d2φ	B	L	H	Dφ	mm <sup>2</sup>	AWG	
VF1.25-3A	3.2	5.5	16.3	11.0	4.0	0.5~1.5	22~16	RED
VF1.25-3	3.7	5.5	16.3	11.0	4.0			
VF1.25-3M	3.7	6.6	17.6	11.0	4.0			
VF1.25-4	4.3	8.0	18.3	11.0	4.0			
VF1.25-4M	4.3	6.6	17.6	11.0	4.0			
VF1.25-5	5.3	8.0	18.3	11.0	4.0			
VF1.25-6	6.4	11.6	22.4	11.0	4.0			
VF1.25-8	8.4	13.6	30.0	11.0	4.0			
VF1.25-10	10.5	13.6	30.0	11.0	4.0			
VF2-3A	3.2	8.5	18.7	11.0	4.5	1.5~2.5	16~14	BLUE
VF2-3	3.7	8.5	18.7	11.0	4.5			
VF2-3M	3.7	6.6	17.3	11.0	4.5			
VF2-4	4.3	8.5	18.7	11.0	4.5			
VF2-4M	4.3	6.6	17.3	11.0	4.5			
VF2-5	5.3	9.5	18.2	11.0	4.5			
VF2-6	6.4	12.0	22.0	11.0	4.5			
VF2-8	8.4	12.0	22.0	11.0	4.5			
VF2-10	10.5	13.6	24.9	11.0	4.5			
VF5.5-3	3.7	9.5	26.3	13.7	6.3			
VF5.5-4	4.3	9.5	26.3	13.7	6.3			
VF5.5-5	5.3	9.5	26.3	13.7	6.3			
VF5.5-6	6.4	11.0	28.0	13.7	6.3			
VF5.5-8	8.4	15.0	34.0	13.7	6.3			
VF5.5-10	10.5	15.0	34.0	13.7	6.3			
VF5.5-12	13.0	15.0	34.0	13.7	6.3			
VF8-5	5.3	10.0	29.5	17.0	7.0	8	8	RED
VF8-6	6.4	12.0	31.0	17.0	7.0			
VF8-8	8.4	14.0	37.0	17.0	7.0			
VF8-10	10.5	18.0	38.0	17.0	7.0			

# INSULATED BUTT CONNECTOR

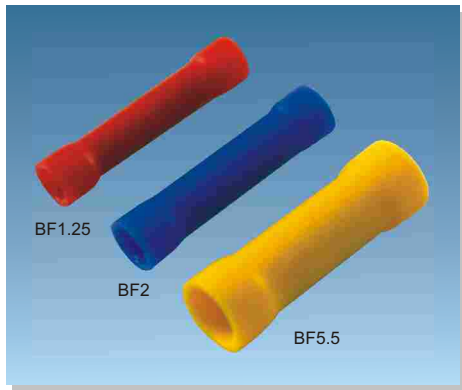

Unit:mm

ITEM NO.	DIMENSIONS				WIRE RANGE		COLOR
	d φ	D φ	L	l	mm <sup>2</sup>	AWG	
BF1.25	1.8	4.0	22.7	15.0	0.5~1.5	22~16	RED
BF2	2.3	4.5	22.7	15.0	1.5~2.5	16~14	BLUE
BF5.5	3.5	6.8	26.7	15.0	4.0~6.0	12~10	YELLOW

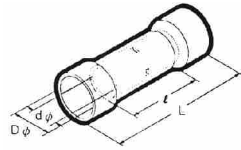

# HEAT SHRINKABLE BUTT CONNECTOR

- TERMINAL MATERIAL: COPPER TUBE
- INSULATION MATERIAL: PE HEAT SHRINKABLE



■ HEAT-SHRINKABLE SEALED CRIMP SPLICES, TERMINALS AND DISCONNECTORS

ITEM NO.	WIRE SIZE	WIRE RANGE		COLOR
		mm <sup>2</sup>	AWG	
BS 1	22-18 A.W.G.(0.5-1.5mm <sup>2</sup> )	0.5~1.5	22~16	RED
BS 2	16-14 A.W.G.(1.5-2.5mm <sup>2</sup> )	1.25~2.5	16~14	BLUE
BS 5	12-10 A.W.G.(4.0-6.0mm <sup>2</sup> )	4.0~6.0	12~10	YELLOW

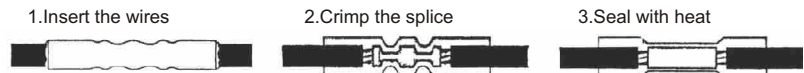

# INSULATED PIN TERMINAL

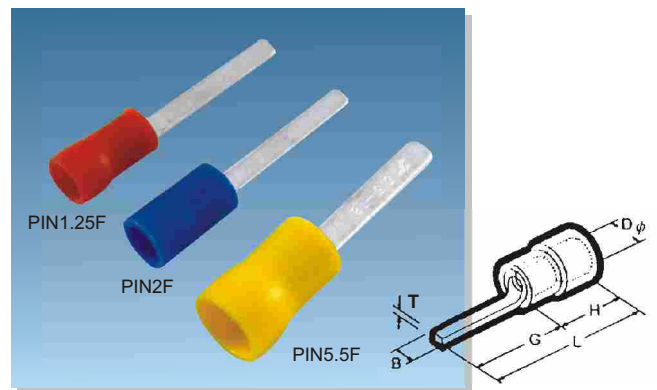

Unit:mm

ITEM NO.	DIMENSIONS						WIRE RANGE		COLOR
	F φ	L	H	B	T	G	mm <sup>2</sup>	AWG	
PIN1.25		22.9	11				0.5~1.5	22~16	RED
PIN2		22.9	11				1.5~2.5	16~14	BLUE
PIN5.5		27.3	16				4.0~6.0	12~10	YELLOW
PIN1.25F(14)		18.5	4.5	3.1	0.8	14	0.5~1.5	22~16	RED
PIN1.25F(18)		22.5	4.5	3.1	0.8	18	0.5~1.5	22~16	RED
PIN2F(14)	2.0	18.5	4.5	3.1	0.8	14	1.5~2.5	16~14	BLUE
PIN2F(18)	2.0	22.5	4.5	3.1	0.8	18	1.5~2.5	16~14	BLUE
PIN5.5F	2.7	24.5	6.5	3.3	1.0	18	4.0~6.0	12~10	YELLOW

## INSULATED MALE CONNECTOR

Unit:mm

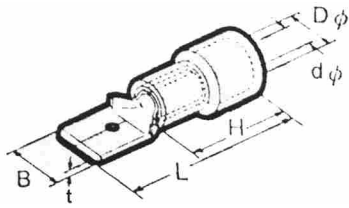

ITEM NO.	DIMENSIONS						WIRE RANGE		COLOR
	B	L	t	dφ	Dφ	H	mm <sup>2</sup>	AWG	
RM110-5	2.8	22.0	0.5	1.8	3.9	10.0	0.5~1.5	22~16	RED
RM110-8	2.8	22.0	0.8	1.8	3.9	10.0	0.5~1.5	22~16	
RM187-5	4.5	22.0	0.5	1.8	3.9	10.0	0.5~1.5	22~16	
RM187-8	4.5	22.0	0.8	1.8	3.9	10.0	0.5~1.5	22~16	
RM250	6.3	22.0	0.8	1.8	3.9	10.0	0.5~1.5	22~16	
BM110-5	2.8	22.0	0.5	2.4	4.2	10.0	1.5~2.5	16~14	BLUE
BM110-8	2.8	22.0	0.8	2.4	4.2	10.0	1.5~2.5	16~14	
BM187-5	4.5	22.0	0.5	2.4	4.2	10.0	1.5~2.5	16~14	
BM187-8	4.5	22.0	0.8	2.4	4.2	10.0	1.5~2.5	16~14	
BM250	6.3	22.0	0.8	2.4	4.2	10.0	1.5~2.5	16~14	
YM250	6.3	24.0	0.8	3.5	5.5	14.0	4.0~6.0	12~10	YELLOW

## INSULATED FEMALE CONNECTOR

Unit:mm

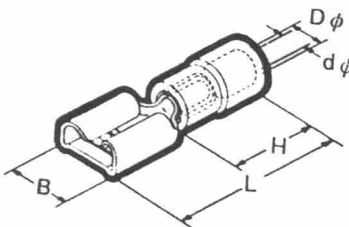

ITEM NO.	DIMENSIONS						WIRE RANGE		COLOR
	B	L	t	dφ	Dφ	H	mm <sup>2</sup>	AWG	
RF110-5	3.3	22.0	0.5	1.8	3.9	10.0	0.5~1.5	22~16	RED
RF110-8	3.3	22.0	0.8	1.8	3.9	10.0	0.5~1.5	22~16	
RF187-5	4.9	22.0	0.5	1.8	3.9	10.0	0.5~1.5	22~16	
RF187-8	4.9	22.0	0.8	1.8	3.9	10.0	0.5~1.5	22~16	
RF250	6.7	22.0	0.8	1.8	3.9	10.0	0.5~1.5	22~16	
BF110-5	3.3	22.0	0.5	2.4	4.2	10.0	1.5~2.5	16~14	BLUE
BF110-8	3.3	22.0	0.8	2.4	4.2	10.0	1.5~2.5	16~14	
BF187-5	4.9	22.0	0.5	2.4	4.2	10.0	1.5~2.5	16~14	
BF187-8	4.9	22.0	0.8	2.4	4.2	10.0	1.5~2.5	16~14	
BF250	6.7	22.0	0.8	2.4	4.2	10.0	1.5~2.5	16~14	
YF250	6.9	24.0	0.8	3.5	5.5	14.0	4.0~6.0	12~10	YELLOW

## INSULATED PIGGY BACK CONNECTOR

Unit:mm



ITEM NO.	DIMENSIONS							WIRE RANGE		COLOR
	B	B1	L	dφ	Dφ	H	t	mm <sup>2</sup>	AWG	
MF1.25	6.8	6.3	22.0	1.8	3.9	10.0	0.8	0.5~1.5	22~16	RED
MF2	6.8	6.3	22.0	2.3	4.2	10.0	0.8	1.5~2.5	16~14	BLUE
MF5.5	6.8	6.3	22.5	3.5	5.5	13.5	0.8	4.0~6.0	12~10	YELLOW

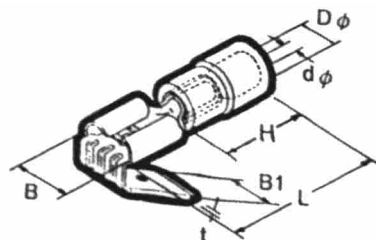



## NYLON FULLY INSULATED MALE CONNECTOR



Unit:mm

ITEM NO.	DIMENSIONS						WIRE RANGE		COLOR
	B	L	t	d $\phi$	D $\phi$	H	mm <sup>2</sup>	AWG	
RM250FLP	6.3	22.0	0.8	1.8	3.9	10.0	0.5~1.5	22~16	RED
BM250FLP	6.3	22.0	0.8	2.4	4.2	10.0	1.5~2.5	16~14	BLUE
YM250FLP	6.3	24.0	0.8	3.5	5.5	14.0	4.0~6.0	12~10	YELLOW

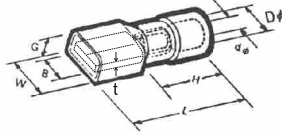

## FULLY INSULATED FEMALE CONNECTOR



Unit:mm

ITEM NO.	DIMENSIONS							WIRE RANGE		COLOR
	B	W	L	d $\phi$	D $\phi$	G	H	mm <sup>2</sup>	AWG	
RF250FLP	6.8	9.6	23.7	1.8	3.9	6.4	7.4	0.5~1.5	22~16	RED
BF250FLP	6.8	9.6	23.7	2.3	4.2	6.4	7.4	1.5~2.5	16~14	BLUE
YF250FLP	6.8	9.6	24.1	3.5	5.5	6.4	7.4	4.0~6.0	12~10	YELLOW
RF250F	6.8	9.6	23.7	1.8	3.9	6.4	7.4	0.5~1.5	22~16	RED
BF250F	6.8	9.6	23.7	2.3	4.2	6.4	7.4	1.5~2.5	16~14	BLUE
YF250F	6.8	9.6	24.1	3.5	5.5	6.4	7.4	4.0~6.0	12~10	YELLOW

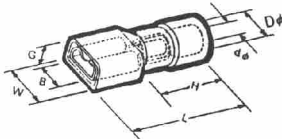

## QUICK SPlice CONNECTOR



Unit:mm

ITEM NO.	DIMENSIONS		WIRE RANGE		COLOR
	L	B	mm <sup>2</sup>	AWG	
3MR	20	22	0.5~1.5	22~16	RED
3MB	20	22	1.5~2.5	16~14	BLUE
3MY	21	32	4.0~6.0	12~10	YELLOW
9080501			0.5~1.5	22~16	RED
9080502			1.5~2.5	16~14	BLUE
90811			0.5~1.5	22~16	RED
90812			1.5~2.5	16~14	BLUE
90813			4.0~6.0	12~10	YELLOW

## PLUG-IN WIRE CONNECTOR



### Specification:

- \* Housing Material: Thermoplastic, UL94V-2 flame retardant.
- \* Current: 24A (VDE).
- \* Voltage: UL-600V, VDE-450V.
- \* Working Temp: 110°C.
- \* Wire Range: 12-22 AWG Solid conductor.



- \* Stripping Length: 11mm (0.43 inch).
- \* Color: Coded according to different position.
- \* UL File No: E-113650

ITEM NO.	COLOR	mm <sup>2</sup>	POLES	PCS/BAG	PCS/CTN..
PC-252	RED	2.5	2	500	5000
PC-253	ORAGNE	2.5	3	500	5000
PC-254	YELLOW	2.5	4	500	5000
PC-255	GRAY	2.5	5	500	5000
PC-258	BLACK	2.5	8	250	2500

## INSULATED BULLET CONNECTOR

Unit:mm



ITEM NO.	DIMENSIONS				WIRE RANGE		COLOR
	d φ	D φ	I	L	mm <sup>2</sup>	AWG	
F1.25A	3.96	3.9	11.0	22.0	0.5~1.5	22~16	RED
F2A(4)	3.96	4.2	11.0	22.0	1.5~2.5	16~14	BLUE
F2A(5)	4.96	4.2	11.0	22.0	1.5~2.5	16~14	BLUE
F5.5A(5)	4.96	5.5	13.7	25.1	4.0~6.0	12~10	YELLOW

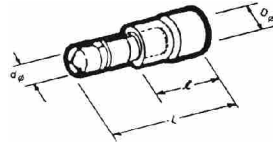

## INSULATED SOCKET CONNECTOR

Unit:mm



ITEM NO.	DIMENSIONS				WIRE RANGE		COLOR
	E	I	L	D φ	mm <sup>2</sup>	AWG	
F1.25B	14.0	10.0	24.0	3.9	0.5~1.5	22~16	RED
F2B(4)	14.0	11.0	25.0	4.2	1.5~2.5	16~14	BLUE
F2B(5)	14.0	11.0	25.0	4.2	1.5~2.5	16~14	BLUE
F5.5B(5)	13.5	12.0	25.5	5.5	4.0~6.0	12~10	YELLOW

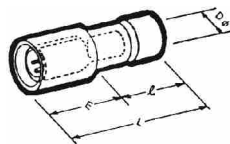

## NYLON FULLY INSULATED BULLET CONNECTOR

Unit:mm



ITEM NO.	DIMENSIONS						WIRE RANGE	
	B	F	L	E	D	d1	mm <sup>2</sup>	AWG
BD1-4AF	4.0	10.5	26.5	10.0	4.2	1.7	0.5~1.5	22~16
BD2-4AF	4.0	10.5	26.5	10.0	4.9	2.3	1.25~2.5	16~14
BD2-5AF	5.0	10.0	23.5	10.5	4.9	2.3	1.25~2.5	16~14
BD5-5AF	5.0	10.0	26.0	13.0	6.5	3.4	4.0~6.0	12~10

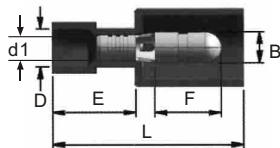

## NYLON FULLY INSULATED SOCKET CONNECTOR

Unit:mm



ITEM NO.	DIMENSIONS						WIRE RANGE	
	B	F	L	E	D	d1	mm <sup>2</sup>	AWG
RE1-4AF	4.0	9.0	25.2	11.0	4.2	1.7	0.5~1.5	22~16
RE2-4AF	4.0	9.0	25.2	11.0	4.9	2.3	1.25~2.5	16~14
RE-2-5AF	5.0	9.0	23.0	10.5	4.9	2.3	1.25~2.5	16~14
RE5-5AF	5.0	9.0	25.5	13.0	6.5	3.4	4.0~6.0	12~10

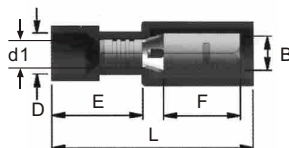

## CLOSE-END CONNECTOR



ITEM NO.	A mm	B mm	C mm	SUITABLE WIRES		APPROVED		CRIMPING TOOLS	PACKING
				MIN	A.W.G.	UL	CSA		
CE-1	18.0	6.2	2.6	Max.2 #20 w/1 #18 Min.2 #22	22~18	UL	SP	AK-25 MR30A	1000pcs
CE-2	19.7	7.9	3.0	Max.1 #18 w/1 #14 Min.2 #22	22~14	UL	SP		
CE-5	25.5	10.5	4.0	Max.3 #18 w/1 #12 Min.2 #22 w/2 #18	22~10	UL	SP		
CE-8	27.7	12.4	5.3	Max.2 #16 w/1 #10 Min.2 #16 w/1 #12	16~10	UL	SP	AK-28(UL) YS-82(UL)	500pcs

● UL and CSA rated at 300 volt, except as noted.

● Temperature rated at 105 °C

UL E113650 SP LR68461

## ALL-PLASTIC WIRE CONNECTOR



ITEM NO.	A mm	B mm	C mm	SUITABLE WIRES A.W.G.	APPROVED		COLOR	PACKING
					UL	CSA		
U1	14.3	8.6	6.5	Max.2 #16 w/1 #22 Min.2 #22	UL	SP	YELLOW	1000pcs
U2	17.2	10.0	7.9	Max.3 #16 Min.3 #20	UL	SP	IVORY	
U3	22.2	11.1	9.1	Max.2 #14Str. w/1 #20 Min.2 #22	UL	SP	IVORY	

● U1, U2 rated at 300 volt, U3 rated at 600 volts.

● Temperature rated at 105 °C

UL E113650 SP LR68461

※without spring

## SCREW-ON WIRE CONNECTOR

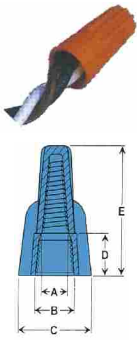

※With spring insert

ITEM NO.	A mm	B mm	C mm	SUITABLE WIRES A.W.G.	APPROVED		COLOR	PACKING
					UL	CSA		
P1	15.2	8.6	6.7	Max.1 #14 w/1#20 Min.2 #22	UL	SP	GRAY	1000pcs
P2	17.6	9.8	7.0	Max.1 #14 w/1 #16 Min.1 #18 w/2 #22	UL	SP	BLUE	
P3	22.0	12.2	9.9	Max.4 #16 w/1 #20 Min.1 #18 w/1 #20	UL	SP	ORANGE	500pcs
P4	24.0	14.0	11.2	Max.1 #10 w/2 #14 w/1 #16 Min.3 #20	UL	SP	YELLOW	
P6	26.5	16.4	13.0	Max.3 #10 Min.3 #18	UL	SP	RED	

● Rated at 300 volt, except as noted.

● Temperature rated at 105 °C

UL LISTED 81U0 E113650 SP LR68461

## SCREW-ON WIRE CONNECTOR-TYPE H

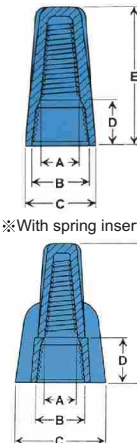

※With spring insert

ITEM NO.	A mm	B mm	C mm	D mm	E mm	SUITABLE WIRES A.W.G.	APPROVED		COLOR	PACKING
							UL	CSA		
P3H	5.0	9.9	12.2	7.8	21.9	Max.4 #16 w/1 #20 Min.1 #18 w/1 #20	UL	SP	ORANGE	500pcs
P4H	6.0	11.2	14.0	7.9	23.8	Max.1 #10 w/2 #14 w/1 #16 Min.3 #20	UL	SP	YELLOW	
P6H	7.0	12.8	16.0	8.9	26.6	Max.3 #10 Min.3 #18	UL	SP	RED	
SP11H	6.4	9.8	18.2	9.0	25.8	Max.3 #12 Min.2 #18	UL	SP	YELLOW	

● Rated at 300volt

● Temperature rated at 105 °C

● Color code to industry standards



# COPPER TUBE TERMINAL

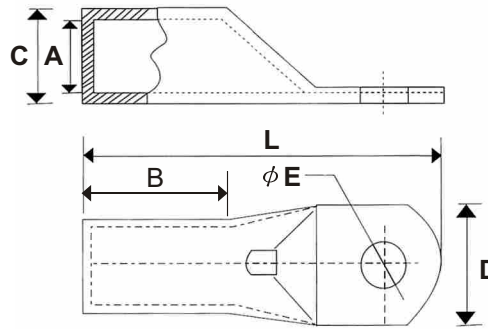

Manufactured from soft drawn pure copper tube to JIS-H3300, C 1020T-0 (Oxygen-Free Copper) which gives the best properties possible.

A complete range terminals, ranging from 1.5mm<sup>2</sup> to 1000mm<sup>2</sup> with cable inspection hole.

ITEM NO.	CABLE SQ.	STUD HOLD SIZE	DIMENSIONS				
		φ E	C	A	D	B	L
CT1.5-4	1.5	4.2	4.0	2.4	8.7	7.0	19.0
CT1.5-5		5.2	4.0	2.4	8.7	7.0	19.0
CT1.5-6		6.5	4.0	2.4	10.0	7.0	20.0
CT2.5-4	2.5	4.2	4.3	2.7	8.7	7.0	19.0
CT2.5-5		5.2	4.3	2.7	8.7	7.0	19.0
CT2.5-6		6.5	4.3	2.7	10.3	7.0	21.0
CT2.5-8		8.4	4.3	2.7	12.0	7.0	23.0
CT4-4	4	4.2	4.8	3.1	8.7	9.5	21.5
CT4-5		5.2	4.8	3.1	8.7	9.5	21.5
CT4-6		6.5	4.8	3.1	10.3	9.5	23.5
CT4-8		8.4	4.8	3.1	12.5	9.5	28.5
CT6-4	6	4.2	5.5	3.8	10.3	10.0	26.0
CT6-5		5.2	5.5	3.8	10.3	10.0	26.0
CT6-6		6.5	5.5	3.8	10.3	10.0	26.0
CT6-8		8.4	5.5	3.8	13.9	10.0	29.0
CT6-10		10.5	5.5	3.8	13.9	10.0	29.0
CT10-4	10	4.2	6.9	4.7	11.9	11.5	27.5
CT10-5		5.2	6.9	4.7	11.9	11.5	27.5
CT10-6		6.5	6.9	4.7	11.9	11.5	27.5
CT10-8		8.4	6.9	4.7	13.5	11.5	30.5
CT10-10		10.5	6.9	4.7	15.0	11.5	30.5
CT10-12		13.0	6.9	4.7	17.0	11.5	34.0
CT16-5	16	5.2	7.8	5.6	12.0	12.0	27.5
CT16-6		6.5	7.8	5.6	12.0	12.0	27.5
CT16-8		8.4	7.8	5.6	13.5	12.0	31.0
CT16-10		10.5	7.8	5.6	16.0	12.0	32.0
CT16-12		13.0	7.8	5.6	17.0	12.0	37.5
CT25-6	25	6.5	9.5	7.1	14.0	13.5	34.0
CT25-8		8.4	9.5	7.1	14.0	13.5	34.0
CT25-10		10.5	9.5	7.1	16.0	13.5	37.0
CT25-12		13.0	9.5	7.1	18.0	13.5	40.0

ITEM NO.	CABLE SQ.	STUD HOLD SIZE	DIMENSIONS				
		φ E	C	A	D	B	L
CT35-6	35	6.5	11.0	8.2	16.5	16.0	39.0
CT35-8		8.4	11.0	8.2	16.5	16.0	39.0
CT35-10		10.5	11.0	8.2	16.5	16.0	43.0
CT35-12		13.0	11.0	8.2	18.0	16.0	43.0
CT35-14		15.0	11.0	8.2	20.0	16.0	48.0
CT40-6	40	6.5	11.2	9.0	17.0	17.0	44.0
CT40-8		8.4	11.2	9.0	17.0	17.0	44.0
CT40-10		10.5	11.2	9.0	17.0	17.0	44.0
CT40-12		13.0	11.2	9.0	18.0	17.0	44.0
CT50-6	50	6.5	12.5	9.5	18.0	20.0	45.0
CT50-8		8.4	12.5	9.5	18.0	20.0	45.0
CT50-10		10.5	12.5	9.5	18.0	20.0	49.0
CT50-12		13.0	12.5	9.5	18.0	20.0	49.0
CT50-14		15.0	12.5	9.5	22.0	20.0	54.0
CT50-16		17.0	14.0	9.5	25.0	23.0	62.0
CT50-20		21.0	14.0	9.5	30.0	23.0	68.0
CT70-8	70	8.4	15.0	11.5	22.0	20.0	47.6
CT70-10		10.5	15.0	11.5	22.0	20.0	51.6
CT70-12		13.0	15.0	11.5	22.0	20.0	51.6
CT70-14		15.0	15.0	11.5	22.0	20.0	62.6
CT70-16		17.0	15.0	11.5	22.0	20.0	62.6
CT70-20		21.0	15.0	11.5	30.0	20.0	62.6
CT95-8	95	8.4	17.0	13.5	25.0	22.0	55.8
CT95-10		10.5	17.0	13.5	25.0	22.0	55.8
CT95-12		13.0	17.0	13.5	25.0	22.0	55.8
CT95-14		15.0	17.0	13.5	25.0	22.0	66.8
CT95-16		17.0	17.0	13.5	25.0	22.0	66.8
CT95-20			21.0	17.0	13.5	30.0	22.0